

Fosroc's Grouts For Precast Construction

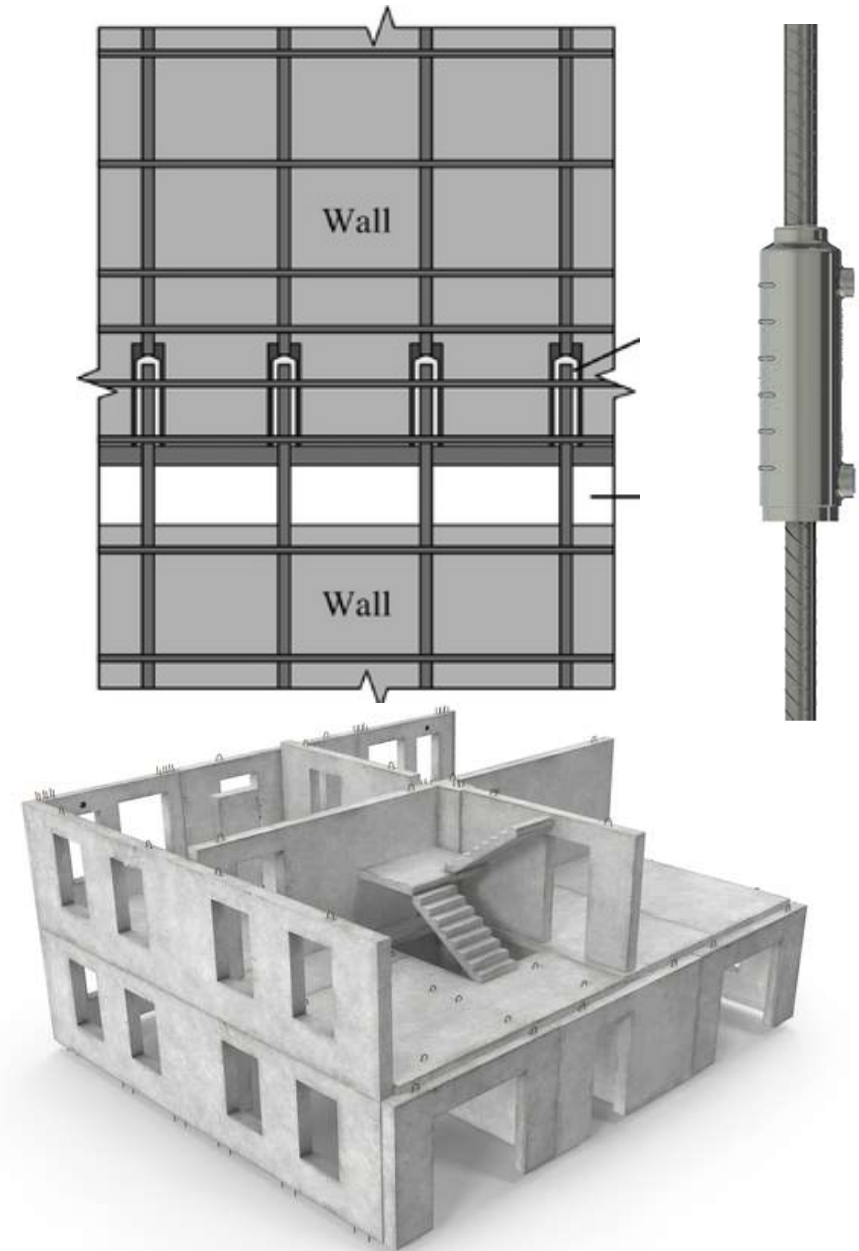

Er Vijay Kulkarni
MTech- Structures

Segment Head- Grouts , Repairs, Coatings
Adhesives



constructive solutions

Specialists in

Constructive Solutions

Fosroc is a world leader in the delivery of tailored Constructive Solutions for virtually any type of construction project, combining high quality products, expert technical support, customer service and innovation.

At the cutting edge of chemical technology, Fosroc specialise in sealants, waterproofing, concrete repair, grouts and anchors, concrete admixtures and protective coatings.

With a comprehensive range of products and a highly developed global network, Fosroc offers a high quality solution for virtually any job, whatever the scale.

Our Solutions



constructive solutions



General Requirements of CC in Precast Construction



constructive solutions



■ Admixture & Surface Treatment

- ▶ Auracast Range – Precast Admixture
- ▶ Concure - Curing Agents

■ General Concrete Repairs

- ▶ Nitomortar FC – Fairing Coat & Filler
- ▶ Rendetroc CS/CF – Crack Sealer & Filler

General Requirements of CC in Precast Construction



■ Waterproofing & Sealants

- ▶ Brushbond Range – Toilets & Utility Area waterproofing
- ▶ Polyurea & Nitoproof Range – Hardscape, Landscape & Terrace waterproofing
- ▶ Nitoseal Range – Joint Treatment Sealants



■ Protective Coatings & Bonding Agents

- ▶ Nitocote Range – Protection of Structure
- ▶ Nitobond Range – Bonding Agent & Site preparation of PMM
- ▶ Nitobond Segmental Glue – Epoxy Segmental Bonding Agent

Grouts

■ *Requirements*

- Non-Shrink & Free flow
- Non-shrink & Thixotropy
- Good Pull-off & Pull-out bond strength
- Good Slant Shear Bond Strength
- Low Water Permeability

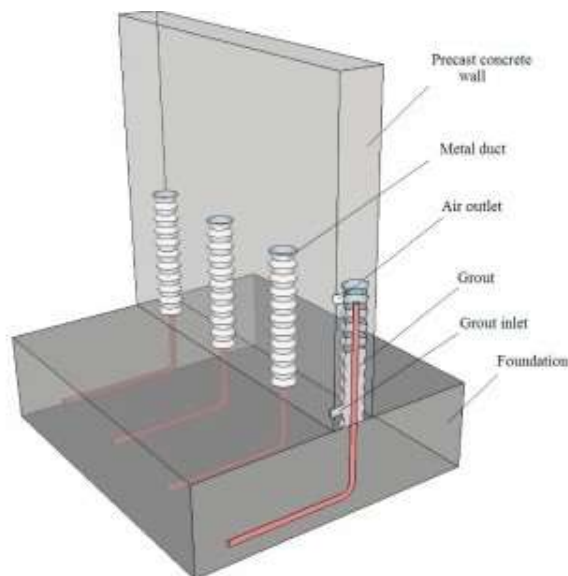
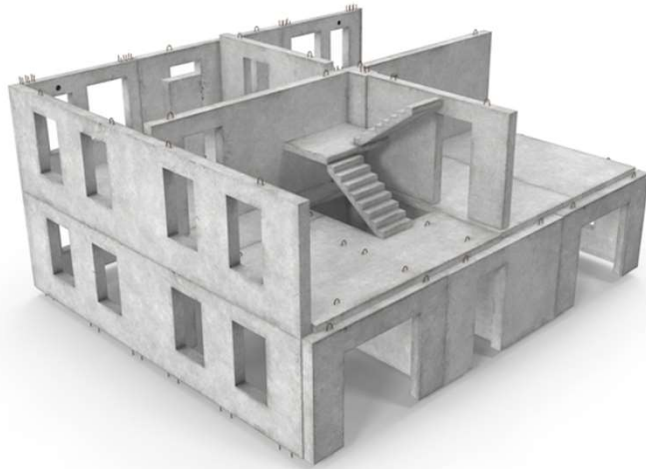

Reference Standards / Codes

Standards for Cementitious Grout

- ASTM C 1107 - Specification for proprietary pre-blended non-shrink cementitious grouts. 3 grades are specified depending on the type of shrinkage compensated.
- ASTM C 939 - Consistency, by measuring efflux time
- ASTM C109 - Compressive strength
- ASTM C1090 - Changes in height of cylindrical specimen (after hardening)
- ASTM C827 - Changes in height of cylindrical specimen at early age
- ASTM C531 - Coefficient of thermal expansion
- ASTM C940 - Expansion and bleeding
- ASTM C942 - Strength of non-shrink grout
- ASTM C953 - Setting time



constructive solutions

Product Range

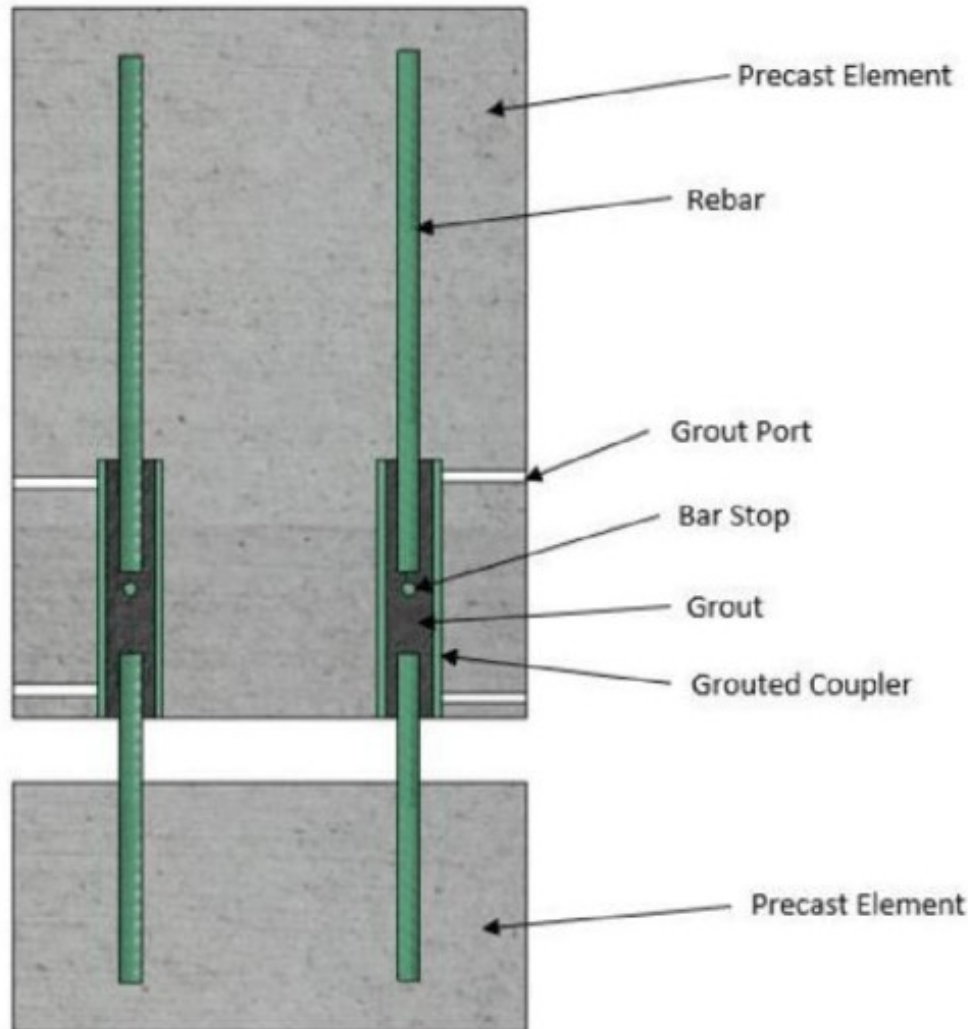

- Conbextra GP2
- Conbextra GP2N
- Conbextra HES
- Conbextra Bedding Mortar

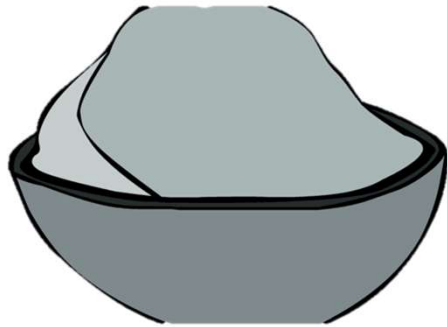

OPC Based



High Early & Ultimate Strength



Low Water permeability

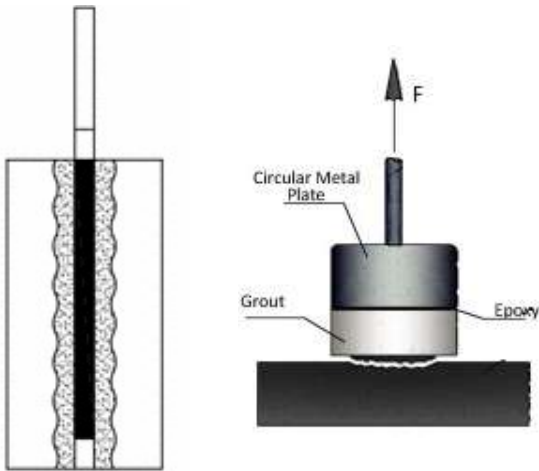

Good Pull-Off & Pull-Out Strength

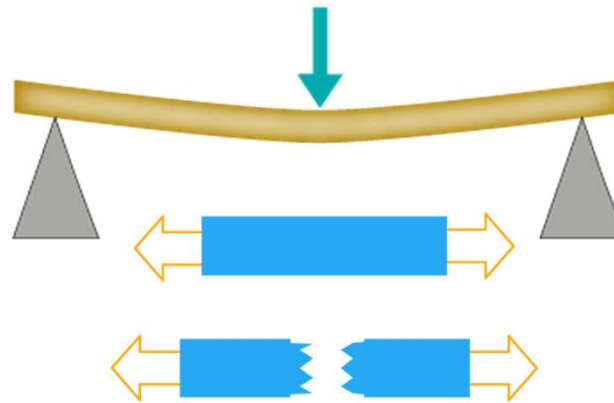

High Flexural & Tensile Strength



Grouting Thickness – 100mm

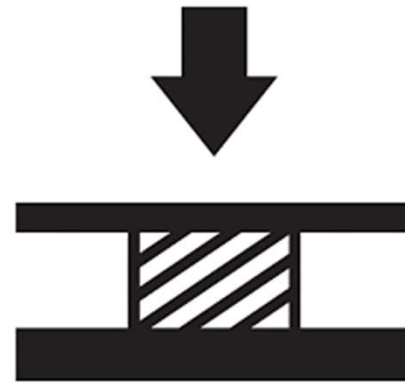
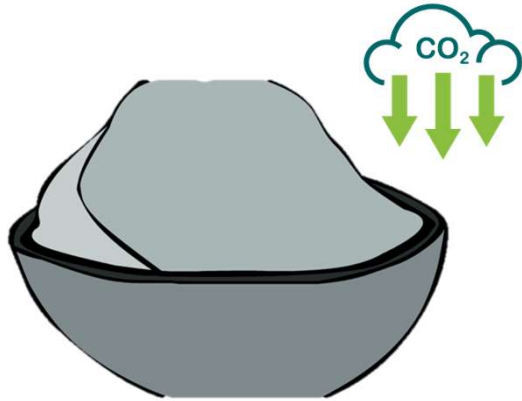

Cementitious Based

High & Ultimate Strength

Low Water permeability

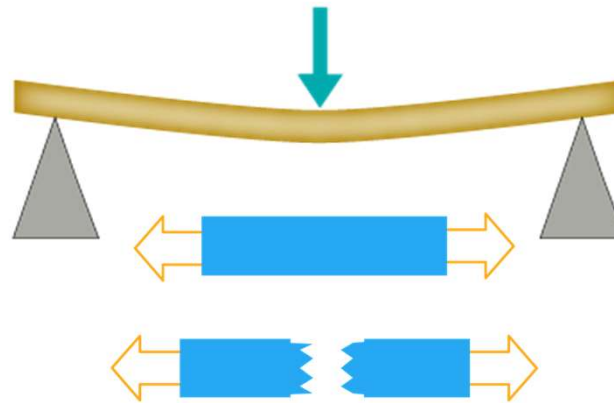
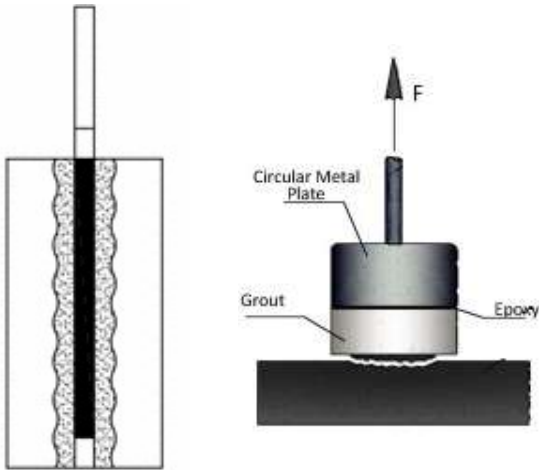

Good Pull-Off & Pull-Out Strength

High Flexural & Tensile Strength

Grouting Thickness – 100mm

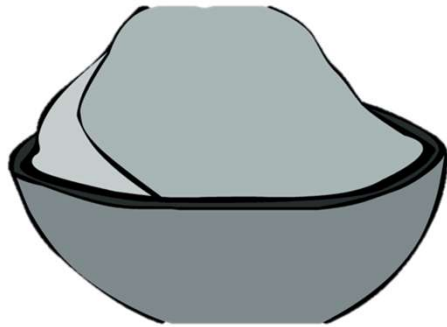

Cementitious Based

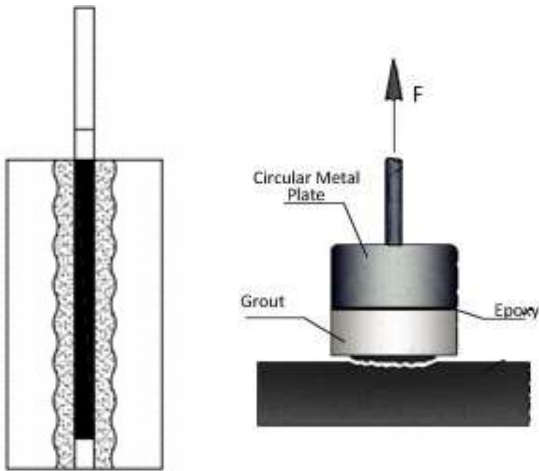

Good Pull-Off & Pull-Out Strength



High hourly & Ultimate Strength

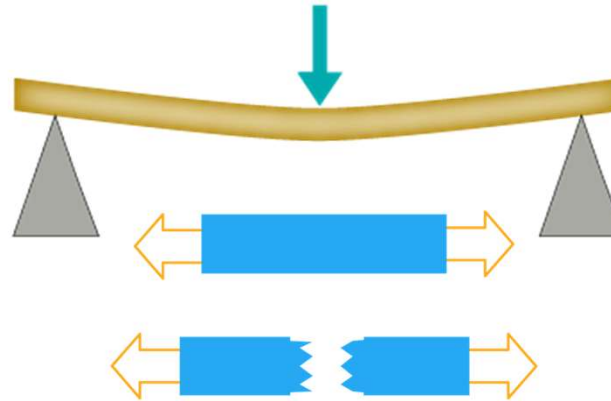

High Flexural & Tensile Strength



Can withstand High Dynamic & Fatigue Loads

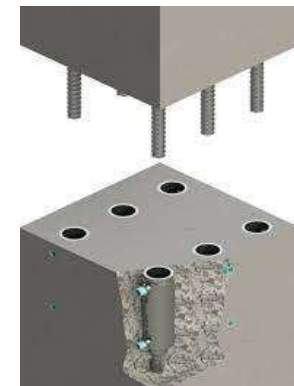

Grouting Thickness – 80mm

Conbextra Bedding Mortar

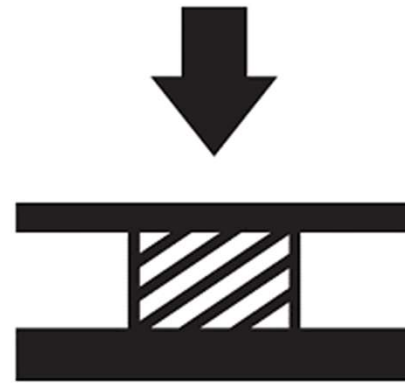

Thixotropic, Non-Sag
OPC Based

High Early & Ultimate
Strength

Low Water permeability

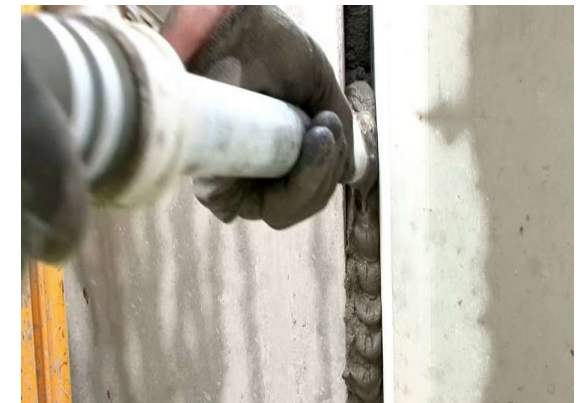
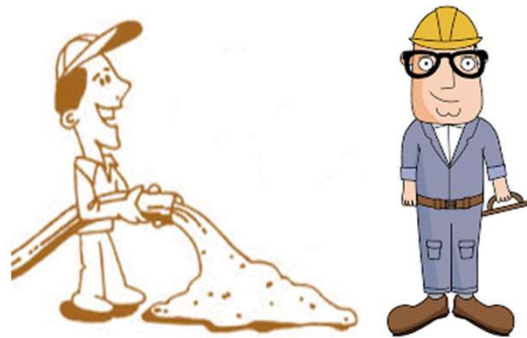
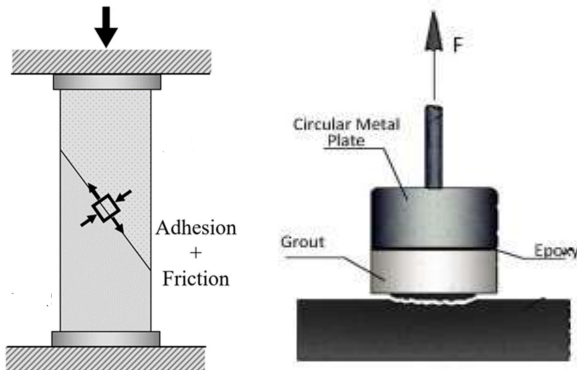

Good Pull-Off & Slant Shear
Strength

Pumpable & hand applied

Applicable for vertical &
over head applications





constructive solutions

THANK YOU